

Wall Bracket Mounting with GV-Mount211-11



Packing List

1. GV-Mount211-11	2. Screw (4 x 10 mm) x 3
3. Screw (4 x 25 mm) x 3	4. Waterproof Ring x 3
5. Plastic Anchor (6 x 29 mm) x 3	6. Drill Template Paster

Applicable Models

- GV-GFER6900 / GFER12800

Dimensions

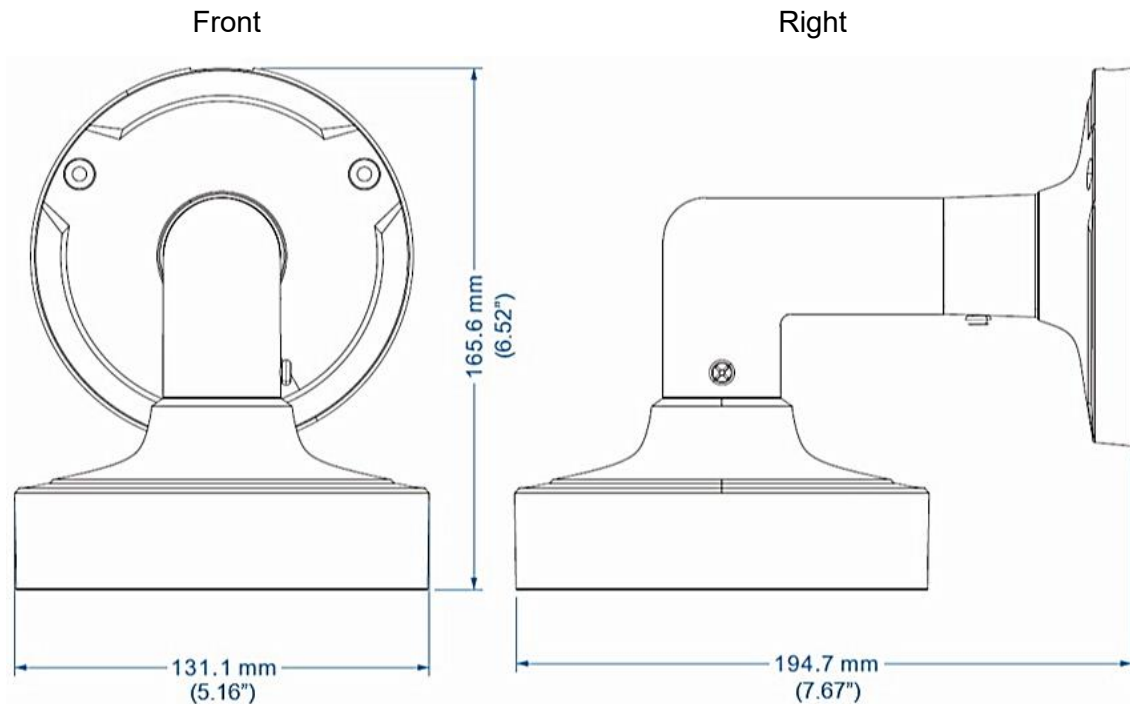

Installation

The steps below show an example installation of **GV-GFER6900** using **GV-Mount211-11**.

1. Install the sponge and the rubber plug respectively to the mounting base.

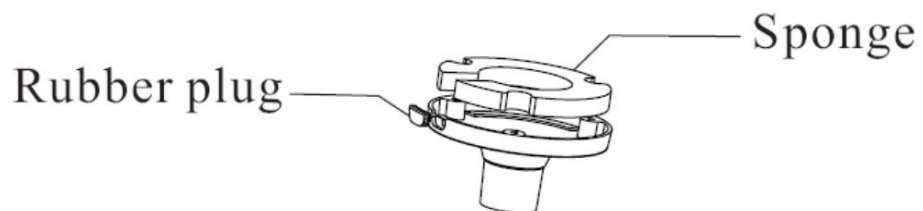

2. Install © to the mounting base according to the screw thread.

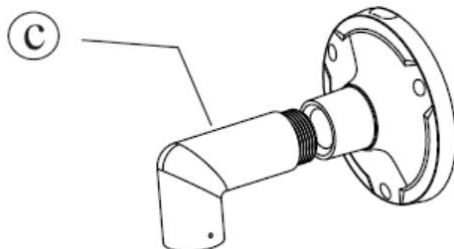

3. Attach the drill template to the place where you want to fix the bracket. Then drill the screw holes according to the drill template.

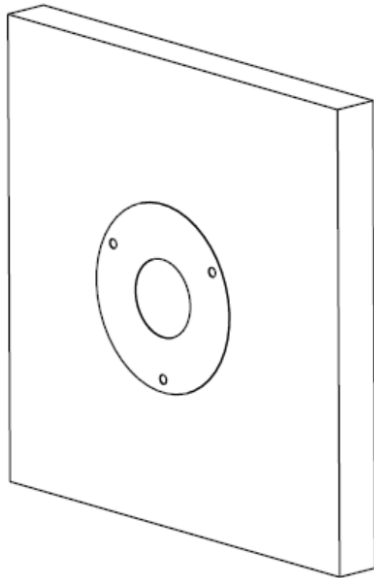

4. Tear off the drill template and insert the plastic plugs.

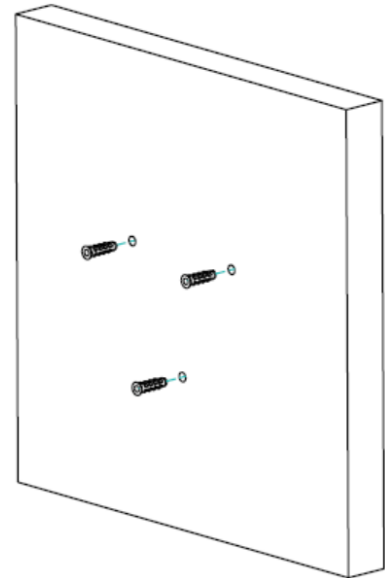

5. Fix the mounting base to the wall with the screws provided.

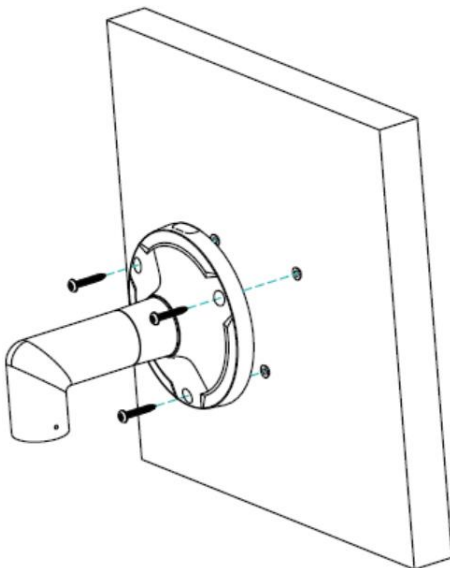

6. Mount the water-proof ring to ④, and then screw ④ with the water-proof ring into ③.

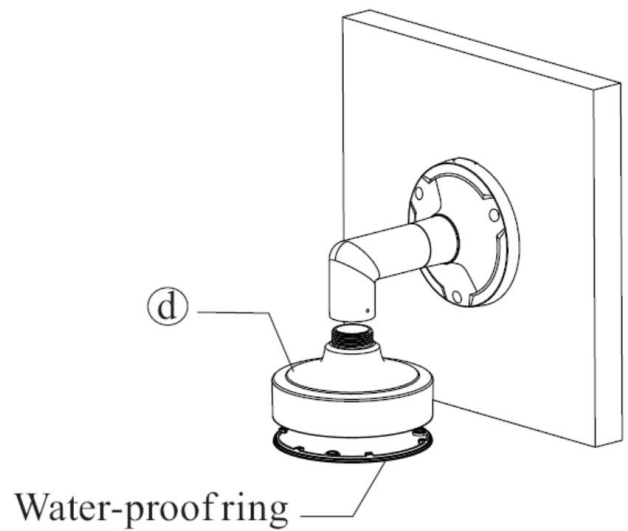

7. Remove the fixed ring from the gap of the camera and then open the cover of the microSD card slot. After that, insert a microSD card.

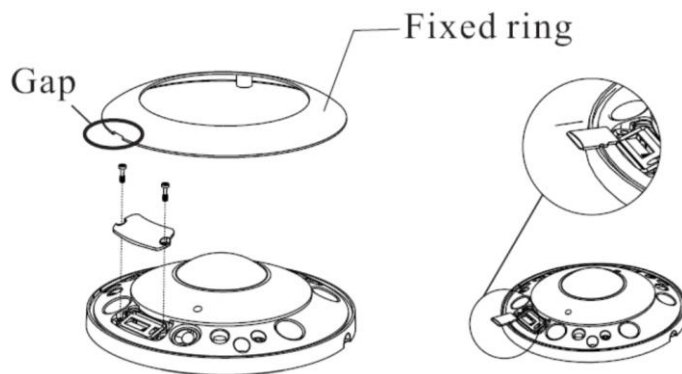

8. Install the cover of the microSD card slot and then fasten the camera onto the bracket with screws.

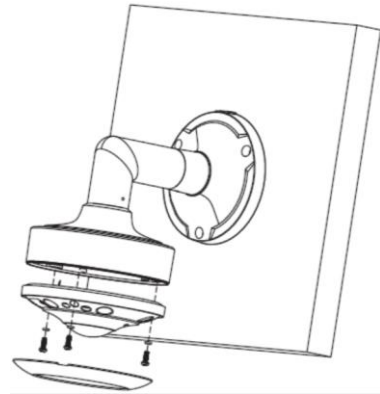

9. Install the fixed ring back to the camera and then fix the bracket with screws.

